

## Aluminium Window Installation Guide

### Before You Start

Read this guide all the way through before starting.

Check the size of the opening against the Window outer frame to ensure a good fit.

Ensure you have all components available - cills, end caps, gaskets, packers etc

Ensure you have a glazing wedge

1

Set the cill in the required position.

Make sure that the cill is absolutely level.

Seal to wall and around as required.

2

The Window can now be positioned on the cill and in the opening.

Use packers in the corners to hold the Window in place and to ensure it remains level, plumb and square. To check the outer frame is square measure the diagonals. There should be no more than 1 to 2mm difference between A and B

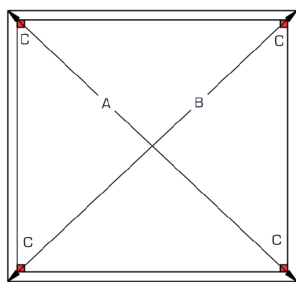

3

Fix through the thermal break at the bottom into the cill (do not screw through the drain holes).

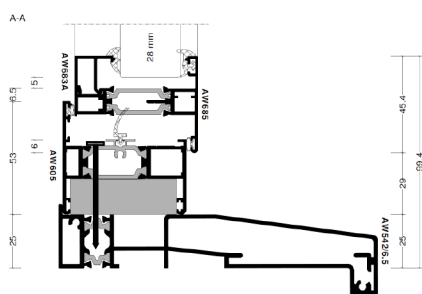

4

The first fixing must always occur within 150mm of each corner and at no more than 600mm centres, Do not over tighten fixings. Packers should be used around the fixings to prevent distortion of the frame. Foam can be used but it is not an alternative to screw fixing and care should be taken not to come into contact with the painted finish or around trickle vent positions.

Fix the outer frame into brickwork up both sides.

Fix the head of the outer frame into brickwork or steel above.

Double check the diagonals to make sure they are still equal.

Fixing lugs can be used as alternative when direct fixing is not required

5

Remove the glazing beads from the window.

Trim back external gaskets as required.

It is vital that all opening windows are 'toe and heeled' correctly. Failure to toe and heel correctly will result in the windows not operating properly.

Using the glazing packers supplied, pack the bottom corner of the hinge side, top corner of the opposite.

Lift the glass into place and fit extra packers where required to take up any slack. Refit the glazing beads.

Fit trickle vents when provided.

6

Fit the wedge gasket.

Over stack the gaskets to allow for an amount of shrinkage.

These are a very tight fit particularly on slim sashes and can be difficult to fit. Using a glazing wedge force the wedge in between the glass and the bead,

Tips:

- Soften the gaskets in warm soapy water.
- Use glass cleaner or similar to help slide the gasket in.
- Use a glazing packer as close to each corner as possible to help create and maintain the required gap.

8

Silicone seal internally and externally, clean down.